

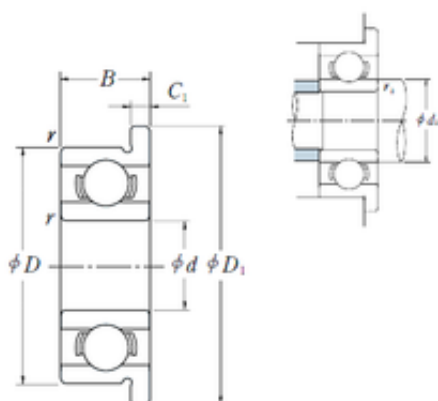

BEARING BOWER CORP.



1,5 mm x 4 mm x 1,2 mm NSK F681X deep groove ball bearings

Bearing No. F681X

F681X Bearing 2D drawings and 3D CAD models

Size	1.5x5x1.2 mm
Bore Diameter	1,5 mm
Outer Diameter	5 mm
Width	1,2 mm
d	1,5 mm
D	4 mm
D1	5 mm
B	1,2 mm
r min.	0,05 mm
C1	0,4 mm
da min.	1,9 mm
ra max.	0,05 mm
Weight	0,09 Kg
Basic dynamic load rating (C)	112 kN
Basic static load rating (C0)	33 kN
(Grease) Lubrication Speed	100000 r/min
SRI	0.32
hidYobi	F681X
LangID	1
D_	4
SREX	0.01
C	0.112
B_	1.2
hidTable	ecat_NSESBMF
C0r	3.5



BEARING BOWER CORP.

Oil rpm	120000
SRE	0.34
mass	0.09
GRS rpm	100000
ra	0.05
SRIX	0.01
Cr	11
SRIN	0
C_1	0.4
C0	0.033
fo	13.095
SREN	0
D_1	5
DE_	3.2
Prod_Type3	ESM_MD_WF_OT
da	1.9
DA_	0.6
Z_	7
yobi	F681X
SDM_	2.6
r	0.05
KBRG	6102
DI_	2
B0	1.2