

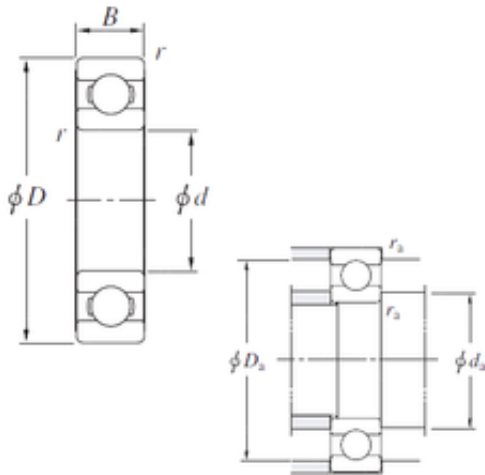

BEARING BOWER CORP.



250 mm x 349,5 mm x 46 mm KOYO SB5035
deep groove ball bearings

Bearing No. SB5035

Size	250x349.5x46 mm
Bore Diameter	250 mm
Outer Diameter	349,5 mm
Width	46 mm
d	250 mm
D	349,5 mm
B	46 mm
r min.	2,1 mm
da min.	261 mm
Da max.	338,5 mm
ra max.	2 mm
Weight	13,1 Kg
Basic dynamic load rating (C)	197 kN
Basic static load rating (C0)	238 kN

SB5035 Bearing 2D drawings and 3D CAD models