

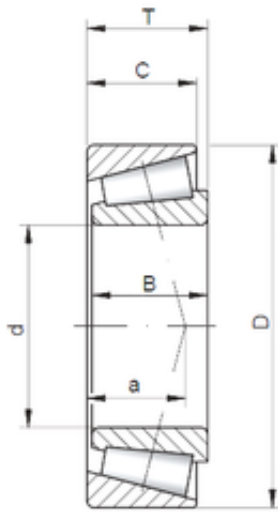

## BEARING BOWER CORP.



220 mm x 285 mm x 40 mm ISO T2DC220  
tapered roller bearings

Bearing No. T2DC220

Size	220x285x41 mm
Bore Diameter	220 mm
Outer Diameter	285 mm
Width	41 mm
d	220 mm
D	285 mm
T	41 mm
B	40 mm
C	33 mm
a	45 mm

T2DC220 Bearing 2D drawings and 3D CAD models