

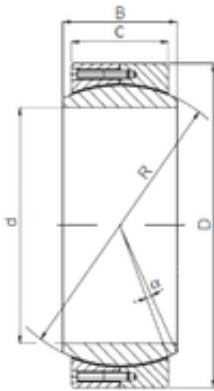

BEARING BOWER CORP.

440 mm x 600 mm x 218 mm ISO GE440DW
plain bearings



Bearing No. GE440DW

Size	440x600x218 mm
Bore Diameter	440 mm
Outer Diameter	600 mm
Width	218 mm
d	440 mm
D	600 mm
B	218 mm
C	185 mm
R	520 mm
Angle	3,9 °

GE440DW Bearing 2D drawings and 3D CAD models